



ELT-01 Tensile Telemetry Load Link



Euroload Limited standard tensile telemetry load links come with the following features,

Ergonomically designed load cell,

Lightweight aerospace grade aluminum construction,

Battery's simply removed. No tools required,

50 hours continuous use on 3 AA battery's,

Can sleep up to 18 months,

Link remote power down,

433 Mhz or 903 Mhz modules available,

IP67 ingress protection. Design verified to 14 meters water depth,

Internal antenna with 500 meters range, no loss of range due to obstructions,

Overload monitoring built into handset,

Dongle available to capture data direct to PC.

Tel: +44 1224 774115 info@euroload.eu

Handset description.

The Euroload (ELT01) hand held weight display unit is available in cabled or wireless versions. The tactile switch membrane is ergonomically designed to allow use with one hand. The environmentally sealed unit has an easily accessible battery compartment and uses three AA batteries.

All calibration and function settings are made through the keypad with prompts in clear text. The ELT01 also features 5 point linearization calibration and all units feature zero, tare and peak hold as standard.

The radio versions are available for 900 MHz, 433 MHz or 2.4 GHz and feature remote sleep command to the transmitter on power down. Up to 99 addresses id codes may be selected. All calibration data is held in the transmitted data.

Accessories include a rubber cover with lanyard eye, and serial communication package with data logging software or simple print out.

Display: 8 digits , 8mm high LCD backlit character displays.

Enclosure: 200mm x 95mm x 30mm

Operating Temperature: -10 to +40 degrees C

Input Range: Selectable 15 mV, 30Mv or 2V

Update Speed: 7, 30 or 1ips-user selectable.

Internal resolution: 3000,000 counts for 10mV input (2mV per volt load cell)

Calibration: Keyboard routine.

Power: 3 x AA type batteries

Power consumption: 50 hours continual, Handset sleep greater than 1 year.

Load link accuracy: +/- 1% of applied load.

Factor of safety: 5:1

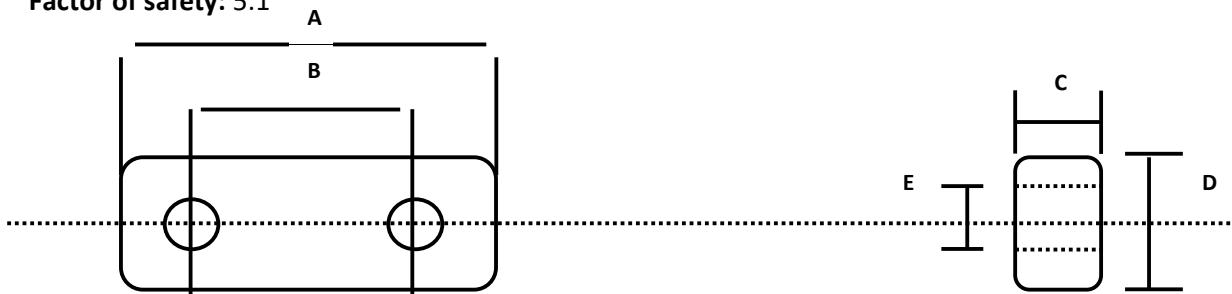

TONNE	A	B	C	D	E	Weight (Kgs)
6.5	304	238	32	117	27	5
13.5	344	250	52	130	40	10
25	416	270	62	136	55	13
35	440	280	70	145	62	14
55	500	280	85	160	75	15
85	588	340	115	188	86	30
100	640	360	120	188	100	34
120	712	400	125	206	100	45
150	790	400	130	254	120	57
200	805	420	160	265	135	115
300	1000	550	180	325	155	220
400	1240	656	200	460	182	350

ALL SIZES IN MM